

# CABLE ROUTING TT500C/TT500D

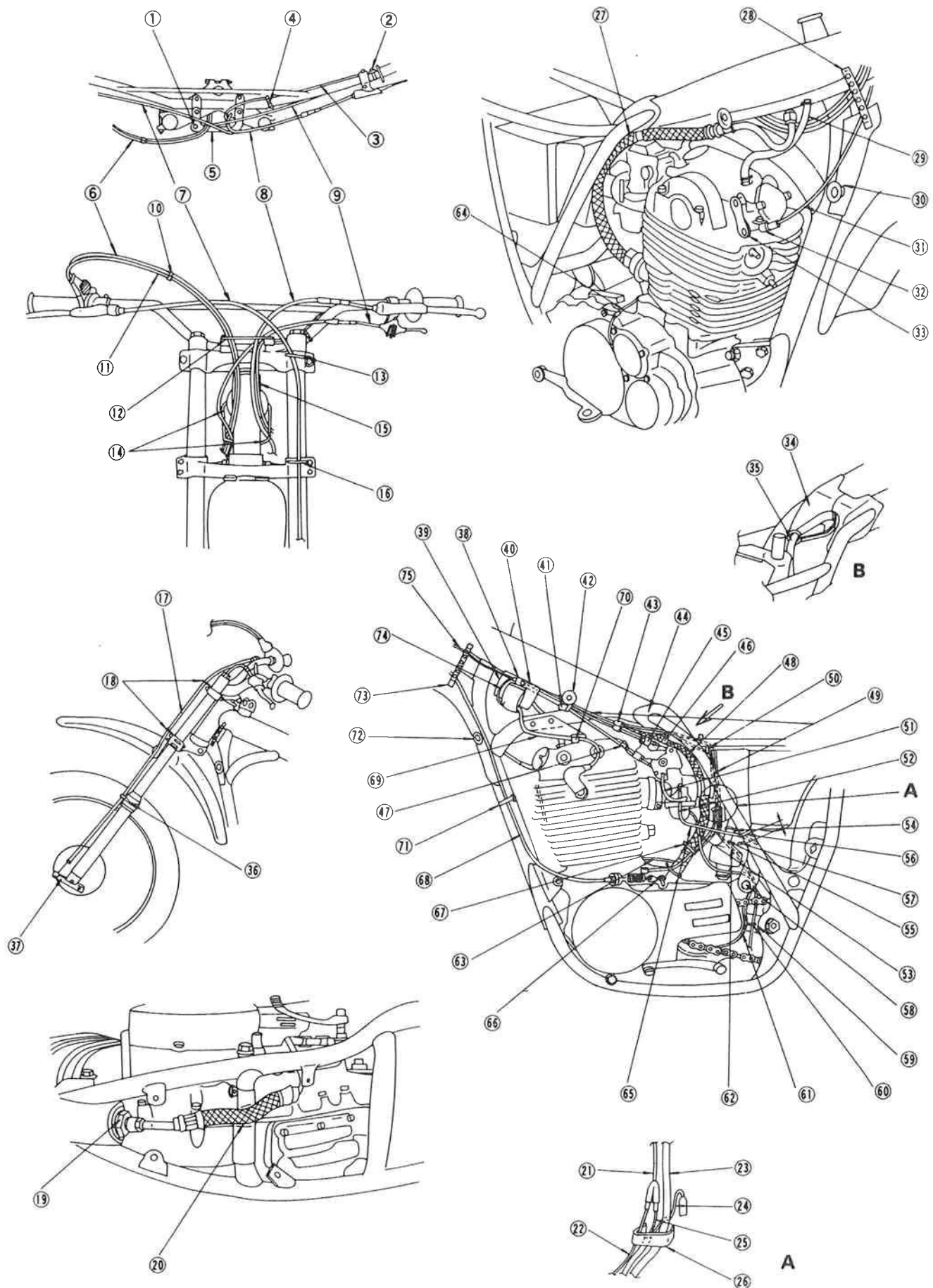

1. Hole for breather-pipe from the fuel tank
2. Engine stop switch
3. Switch cord
4. Switch cord band  
(437-83936-00)
5. Wire guide
6. Throttle wire
7. Brake wire
8. Clutch wire
9. Decomp. wire
10. Wire clip
11. Throttle wire  
\* Be careful not to be twisted two throttle wires.
12. Wire guide
13. Wire guide
14. Wire guide
15. Switch cord
16. Wire guide
17. Brake wire
18. Wire guide
19. Filter net
20. Inlet oil hose
21. Sublead wire
22. Braker-lead wire
23. Generator breather pipe
24. Cord for lamp kit
25. Flywheel magnet lead wire
26. Clamp (in a body of air cleaner)
27. Outlet oil pipe  
\* Keep oil pipe off from the carburator.
28. Wire guide
29. Breather pipe
30. \* Pass above the tank bracket
31. Decomp. wire
32. Decomp. bracket
33. Decomp. lever
34. Main pipe lug
35. Generator breather pipe
36. Wire holder
37. Camshaft lever
38. Clamp  
\* Cover with vinyl-tube.  
Clamp the connector.
39. Coil bracket
40. Throttle wire  
\* Pass through the oil outlet pipe and bracket coil.
41. Clamp  
\* Clamp only sublead wire.
42. Rocketing damper
43. Clip  
\* Fasten wire-sublead and upside of throttle-wire with clip.
44. Lug main pipe
45. Carburator
46. Clamp 2
47. Throttle wire (silver colored tube is attached)
48. Outlet oil pipe
49. Sublead wire
50. Clamp 3
52. Fuel pipe
52. Air ventilation pipe
53. Overflow pipe
54. Clip band
55. Breather assembly
56. Band
57. Side cover hook
58. Upper rear engine M.T.
59. \* Pass overflow pipe through the rear arm guide pipe.
60. Guide pipe
61. Flywheel magneto lead for lamp kit
62. Pass the flywheel magneto lead to the right side of the breather assembly.
63. Braker lead wire
64. Braker lead wire
65. Air ventilation pipe  
\* Be sure not to be loosened.
66. Clutch lever
67. Band
68. Clutch wire
69. High tension cord
70. Clamp
71. Wire band
72. Tank fitting bracket
73. Wire guide
74. Coil lead wire
75. Switch cord

# CABLE ROUTING XT500C/XT500D

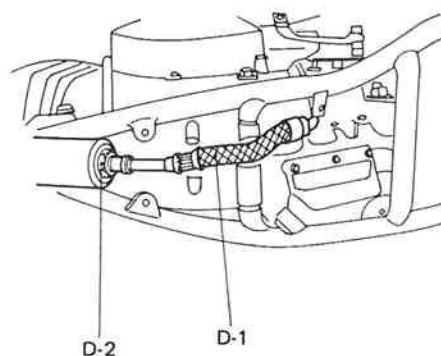
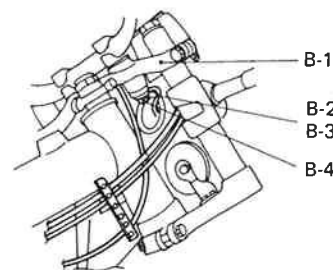
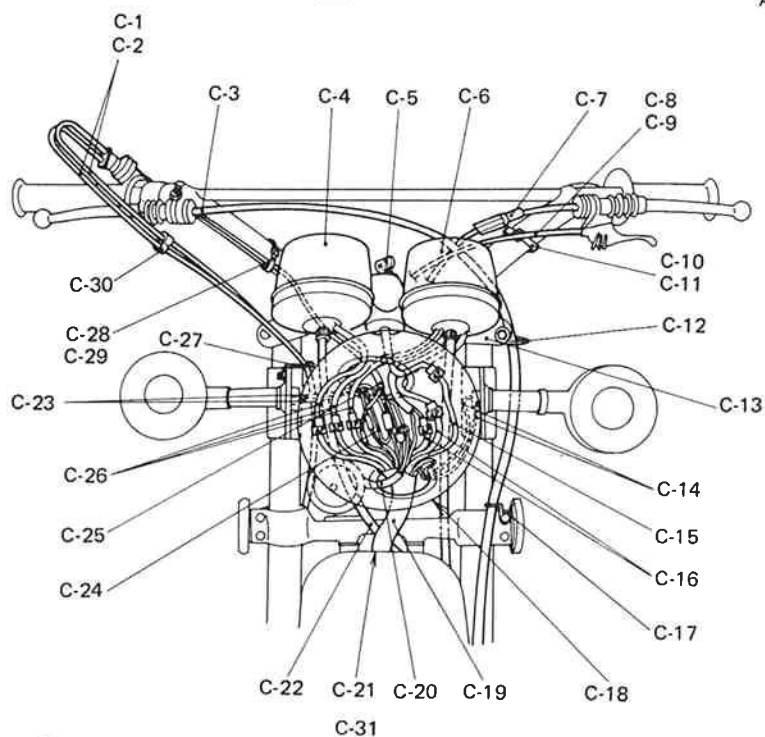
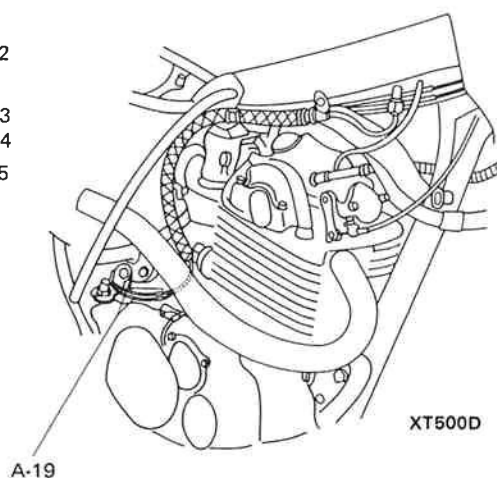
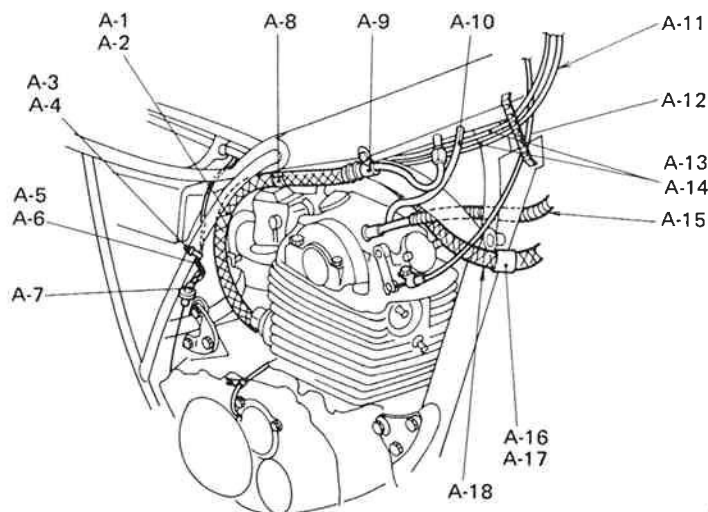

## ENGINE BOTTOM

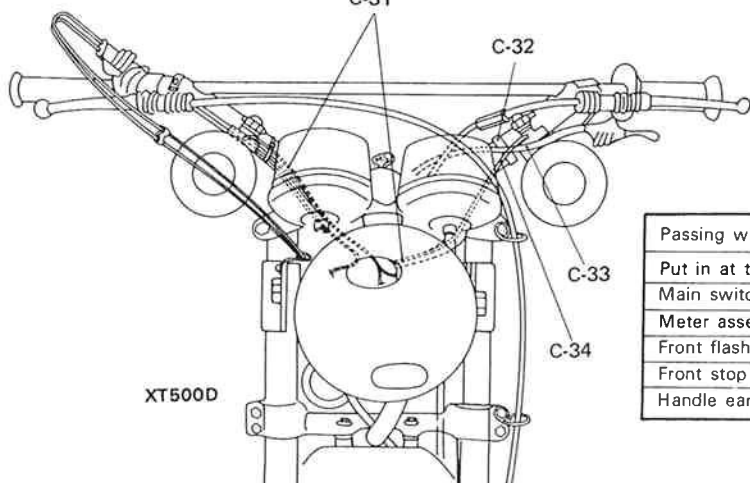

XT500D

Passing wire harness in to headlamp body

Put in at top hole	Put in at bottom hole
Main switch lead wire	Main harness
Meter assembly lead wire	Horn lead wire
Front flasher right side lead wire	Front flasher left side lead wire
Front stop switch lead wire	
Handle earth lead wire	

## SECTION A

- A-1 Oil outlet hose
- A-2 Goes on carb. right
- A-3 Band
- A-4 Hold staf switch lead wire to seat pillar with band
- A-5 Stop switch lead wire
- A-6 Goes on top of air cleaner
- A-7 Rear stop switch
- A-8 Clamp to frame on upper left of carb.
- A-9 Clamp
- A-10 Breather pipe
- A-11 Cross throttle and decomp. wires with latter on former
- A-12 Wire guide
- A-13 Throttle wire
- A-14 Lay-out in parallel with main pipe so that it does not hang loose
- A-15 Locate tachometer cable above wire harness
- A-16 Main harness
- A-17 Tape here
- A-18 Do not let wire harness hang loose
- A-19 Stop switch lead wire  
Keep distance of over 25 mm (1.0 in) from exhaust pipe

## SECTION B

- B-1 Handle crown
- B-2 Handle earth lead wire
- B-3 Connect inside headlight
- B-4 Handle holder securing nut

## SECTION C

- C-1 Throttle wire
- C-2 Do not get two throttle wires entangled
- C-3 Brake wire
- C-4 Tachometer

- C-5 Main switch
- C-6 Speedometer
- C-7 Clutch wire
- C-8 Decom. wire
- C-9 Does in front of handleber
- C-10 Band
- C-11 Fit where pipe curves
- C-12 Clamp
- C-13 Handle crown
- C-14 Flasher lead wire (left side)
- C-15 Main switch lead wire
- C-16 Handle switch lead wire (left side)
- C-17 Clamp
- C-18 Headlight body
- C-19 Main harness
- C-20 Horn lead wire
- C-21 Cross tachometer cable and wire harness out of hole
- C-22 Tachometer cable.
- C-23 Flasher lead wire (right side)
- C-24 Handle earth lead wire
- C-25 Front stop switch lead wire
- C-26 Meter assembly lead wire
- C-27 Clamp (throttle)
- C-28 Fit where pipe curves
- C-29 Band
- C-30 Clip
- C-31 Front flahser light lead wire
- C-32 Band  
Fit where pipe curves
- C-33 Decom. wire  
Pass above rear of front flasher light
- C-34 Decom. wire  
Pass in front of handlebars

## SECTION D

- D-1 Oil inlet hose
- D-2 Filter net

# CABLE ROUTING XT500C/XT500D

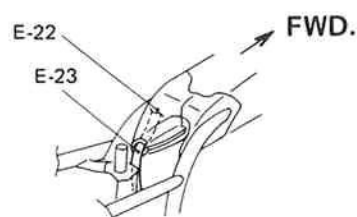
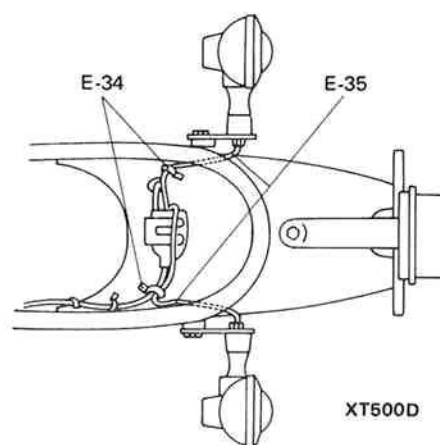
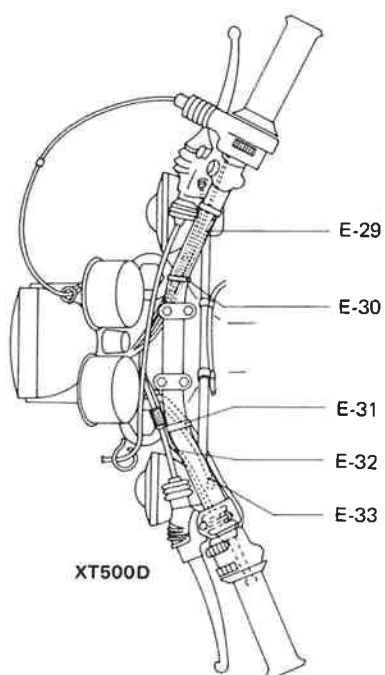
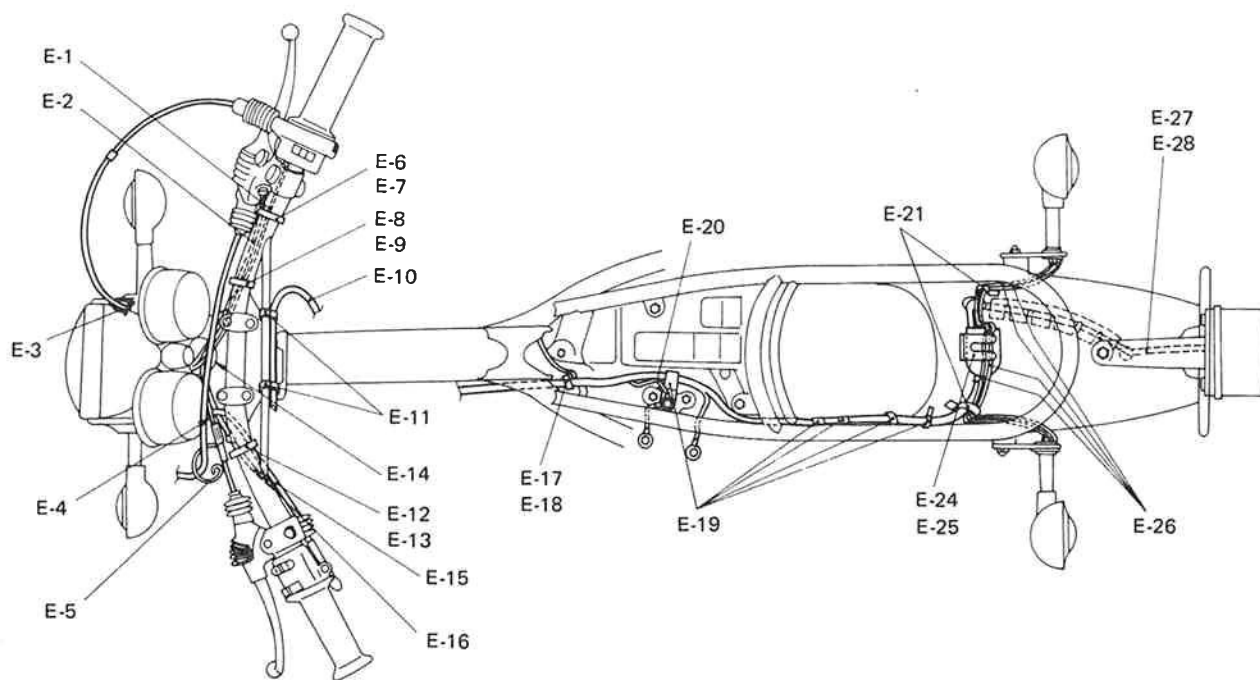

MAIN PIPE REAR END

## SECTION E

- E-1 Cord switch (right side handle)
- E-2 Stop switch lead wire
- E-3 Clamp
- E-4 Pass handle switch lead wire on left of handle crown  
to put it into headlamp body
- E-5 Clamp
- E-6 Band
- E-7 Give some slack to front stop switch lead wire
- E-8 Band
- E-9 Clamp stop switch lead wire and switch cord
- E-10 Breather pipe
- E-11 Pipe clip
- E-12 Band
- E-13 Clamp handle switch lead wire
- E-14 Wire cords passing between meter assembly and  
handle crown are clutch wire, decomp. wire, stop  
switch lead wire and switch cord, four in all
- E-15 Handle switch lead wire (left side)
- E-16 Decompression wire
- E-17 Clamp
- E-18 Clamp under front seat bracket
- E-19 Clamp
- E-20 Earth wire
- E-21 Clamp
- E-22 Main pipe lug
- E-23 Generator breather pipe
- E-24 Clamp
- E-25 Clamp cover after connection
- E-26 Flasher light lead wire
- E-27 Tail/Stoplight lead wire
- E-28 Pass inside license bracket, taking out top of fender  
through its hole and then leading under rear fender  
clamp connections inside rear fender
- E-29 Front flasher lead wire
- E-30 Band  
Clamp stop switch lead wire, switch cord and front  
flasher light lead wire together
- E-31 Band  
Clamp both handlebar switch lead wire and front flasher  
light lead wire
- E-32 Decomp. wire
- E-33 Front flasher light lead wire
- E-34 Clamp
- E-35 Rear flasher light lead wire

# CABLE ROUTING XT500C/XT500D

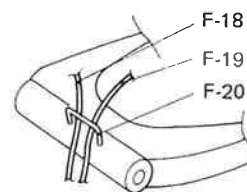
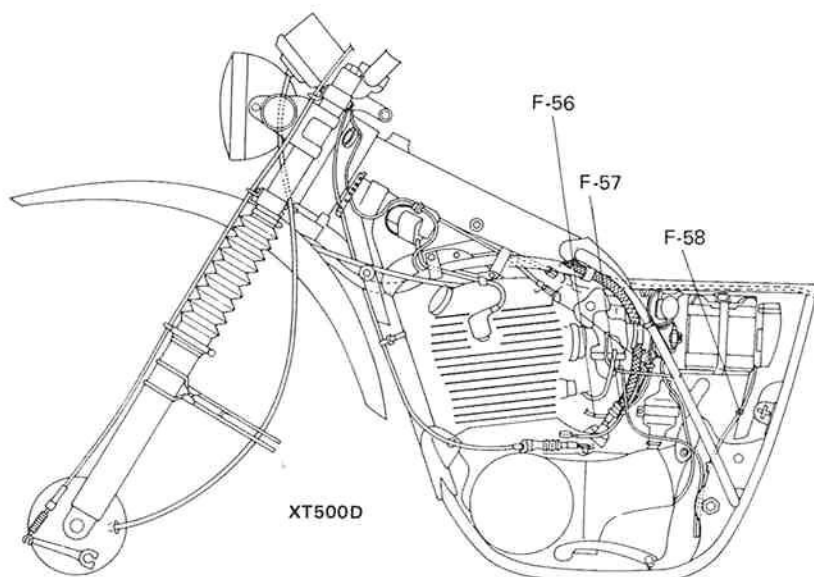
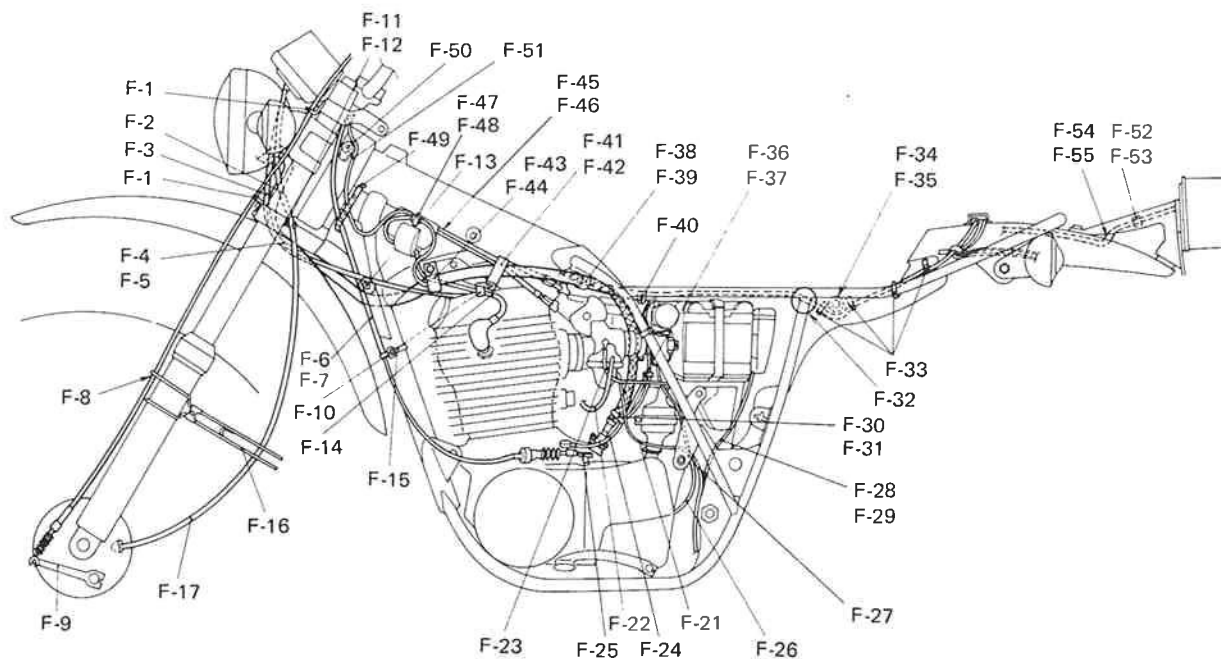

## REAR ARM

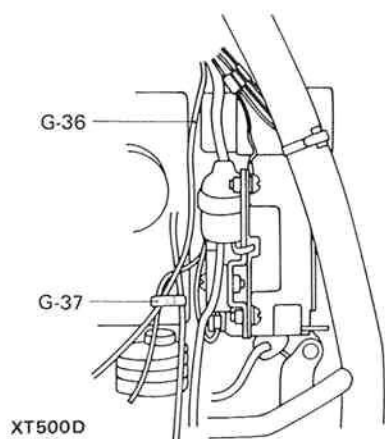

XT500D

## BATTERY BOX VIEWED FROM FRONT

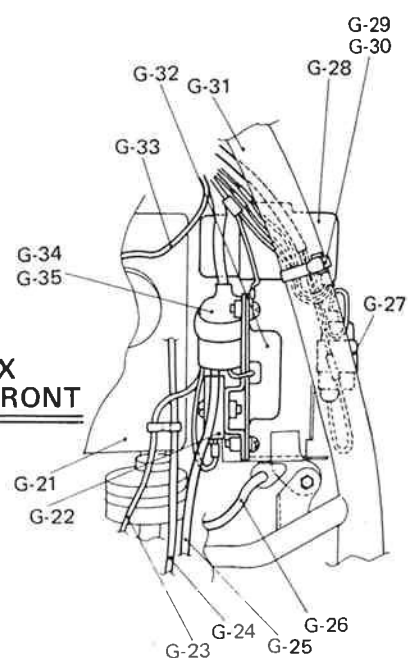

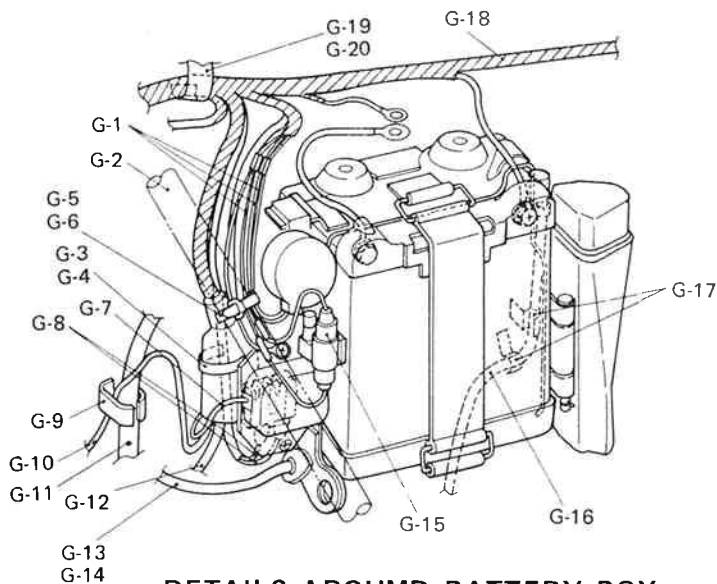

## DETAILS AROUND BATTERY BOX

### SECTION F

- F-1 Clamp
- F-2 Speedometer cable
- F-3 Tachometer cable
- F-4 Main harness
- F-5 Pass in front fender groove
- F-6 Clutch wire
- F-7 Pass in front of down tube
- F-8 Pass through hole
- F-9 Camshaft lever
- F-10 Clamp
- F-11 Clamp
- F-12 Clamp speedometer cable securely
- F-13 Tank fitting bracket
- F-14 High tension cord
- F-15 Band
- F-16 Wire holder
- F-17 Speedometer cable
- F-18 Over flow pipe
- F-19 Breather pipe (battery)
- F-20 Pipe guide
- F-21 Over flow pipe
- F-22 Fuel pipe
- F-23 Air vent pipe
- F-24 Generator breather pipe
- F-25 Clutch lever
- F-26 Flywheel magneto lead wire
- F-27 Pass between right and left brackets
- F-28 Battery breather pipe
- F-29 Let it go down into rear arm guide pipe
- F-30 Band
- F-31 Clamp oil hose, generator pipe and breaker lead wire
- F-32 Pass in frame concavity
- F-33 Clamp
- F-34 Seat fitting boss
- F-35 Pass wire harness under boss
- F-36 Clamp (attached to air cleaner)
- F-37 Pass generator pipe and breather pipe
- F-38 Clamp
- F-39 Clamp oil outlet hose and main harness with latter on outside
- F-40 Clamp
- F-41 Clamp
- F-42 Push in main harness and throttle wire
- F-43 Clamp
- F-44 Push in main harness

- F-45 Throttle wire
- F-46 Pass between oil outlet pipe and coil bracket
- F-47 Clamp vinyl tube covered connection
- F-48 Clamp after cord switch connection
- F-49 Wire guide
- F-50 Steering lock guide
- F-51 Cord switch (kill switch)
- F-52 Clamp
- F-53 After connection
- F-54 Tail/Stoplight lead wire
- F-55 Pass through hole in rear fender, leading it under it
- F-56 Stop switch lead wire
- F-57 Band
- Clamp oil hose, generator pipe, breaker lead wire and stop switch lead wire together
- F-58 Battery breather pipe
- Pass through clamp on mud guard

### SECTION G

- G-1 Flasher relay lead wire
- G-2 Seat pillar tube (frame)
- G-3 Clamp (attached to battery box)
- G-4 Clamp rubber cover securely after lead wire connection
- G-5 Band
- G-6 Fix fuse holder lead wire and flasher relay lead wire to seat pillar tube with band
- G-7 Regulator lead wire
- G-8 Rectifier lead wire
- G-9 Clamp (attached to air cleaner)
- G-10 Breaker lead wire
- G-11 Generator breather pipe
- G-12 Flywheel magneto lead wire
- G-13 Air vent pipe
- G-14 Insert into hole in holder under battery box
- G-15 Fuse holder
- G-16 Battery breather pipe
- G-17 Clamp
- G-18 Main harness
- G-19 Clamp vinyl tube covered connection under front seat bracket
- G-20 Clamp where main harness is branched
- G-21 Air cleaner
- G-22 Rectifier
- G-23 Regulator lead wire
- G-24 Generator breather pipe
- G-25 Flywheel magneto lead wire
- G-26 Air vent pipe
- G-27 Fuse holder
- G-28 Flasher relay
- G-29 Band
- G-30 Fit fuse holder lead wire and flasher relay lead wire securely, so that lead wires do not come out on seat pillar face.
- G-31 Seat pillar (frame)
- G-32 Regulator
- G-33 Stop switch lead wire
- G-34 Rubber cover
- G-35 After lead wire connection, at absorb wire slack in cover.
- Put cover between air cleaner and regulator (above rectifier) and clamp securely particularly care should be taken about this connection.
- G-36 Stop switch lead wire
- G-37 Clamp
- Calmp both stop switch lead wire and regulator lead wire